

## Guide to riding trains

# Guide to riding trains

This guide will explain how to ride trains in detail, including how to use automatic ticket gates so you can make more convenient use of the Kita-Osaka Kyuko Railway.

## Buying tickets and charging IC cards.

### ① Buying tickets from a ticket vending machine

As shown below, there are two types of ticket vending machines.



The red ticket vending machine offers guidance in English.

There is an English button in the upper right corner of the screen, which switches the display to English when you press it.



Check the fare to your station on the fare table posted above the ticket vending machines.

# Guide to riding trains

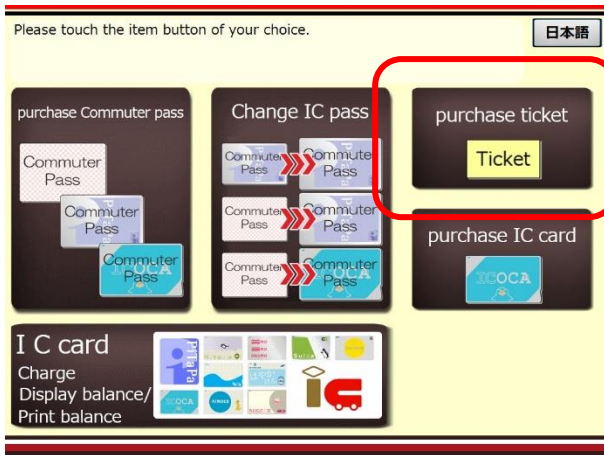

This is the initial screen of the vending machine.

Please pay in cash.

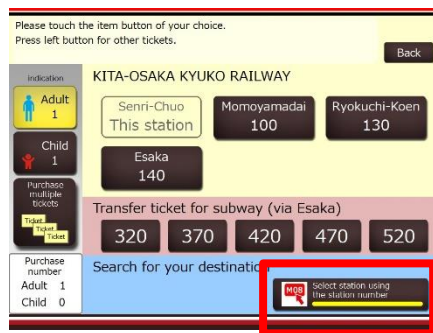

On the touch screen, touch the button that displays the fare to your destination station.

You can also select the station where you will get off the train to determine the fare.

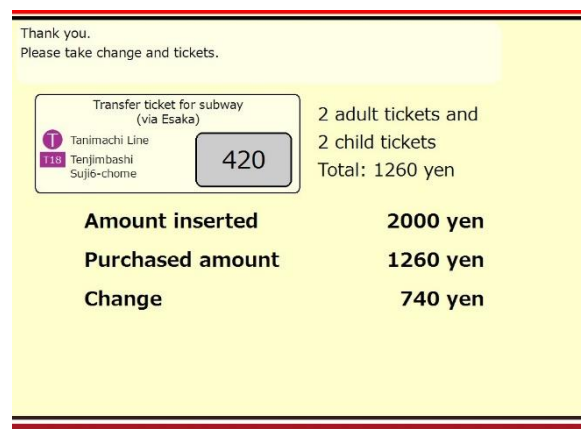
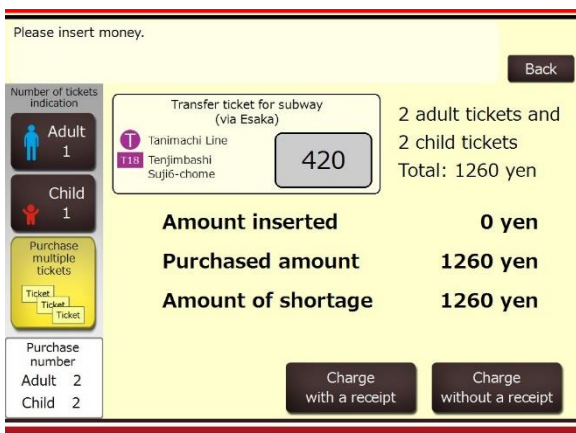
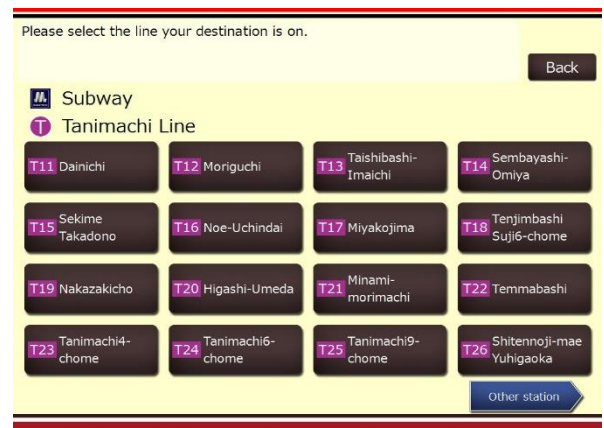

The screen switches to the ticket-issuing display.

Please take your ticket(s). Be sure to take any change.

# Guide to riding trains

## ② Charging an IC card (ICOCA, Suica, etc.)



IC cards can be charged at the red ticket vending machine.

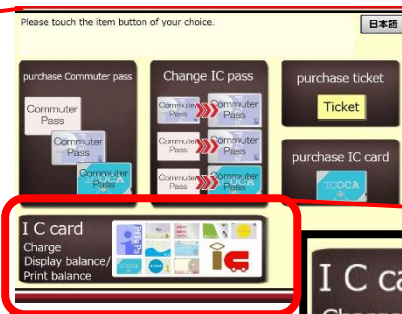

This is the initial screen.



First, insert your IC card.

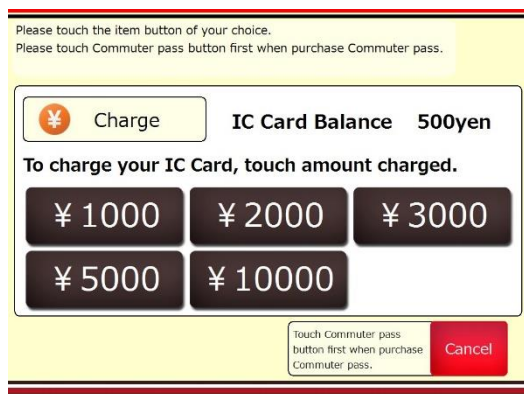

Touch the button on the touch screen that shows the amount that you would like to charge to your card.

# Guide to riding trains



Insert cash.

If you need a receipt, touch the Charge with a receipt button on the bottom right. If you do not need a receipt, touch the Charge without a receipt button.

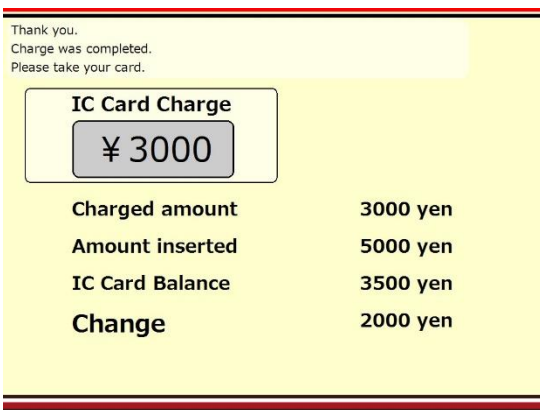

The screen switches to the processing screen.

When the process is completed, you will hear a beep.

Take your IC card. Be sure to take any change and your receipt, if issued.



# Guide to riding trains

## (2) Using automatic ticket gates

When using the train, use the automatic ticket gates at the station to check your ticket.



● Tickets, Magnetic card tickets

○ When boarding

Insert your ticket into the slot in the automatic ticket gate.

Ticket slot



When boarding the train, be sure to take your ticket as you pass through the gate.

○ When you arrive

Insert your ticket into the slot in the automatic ticket gate.

If you are using a regular 1-time ticket, it will be collected by the automatic ticket gate.

If you are using a magnetic card, be sure to retrieve it after passing through the gate.

## Guide to riding trains

Ticket gates labeled IC are for IC cards only.  
They cannot be used with tickets or magnetic cards.

IC card tickets

● IC card tickets (e.g. ICOCA, Suica)

Touch the IC card reader securely with your card.

